

20' Gaff Sloop Ragnar    20' Topsail Sloop    20' Sloop Stern View    20' Yawl Version    20' Marconi Sloop    20' Tall Sloop Rig

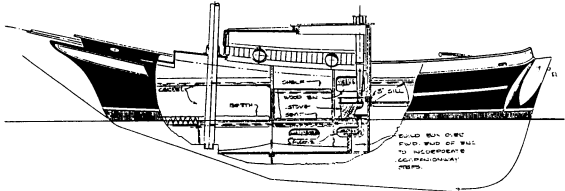

## 20'-26' Friendship Sloops

Designs Number 68, 160, 91 & 138  
1971, 1977, 1972 & 1976

**20:** The first one built to this design was the *Ragnar*, which was our company yacht for a while. We had a great time cruising and daysailing her — and her handsome appearance drew crowds, making it easy for us to meet people wherever we sailed. She's a handsome and handy pocket cruiser for two and can daysail up to six. Her features include a long, straight, ballast keel, cutaway forefoot for easy maneuvering, self-draining cockpit, spacious cockpit and interior, inboard diesel power, with an option for an outboard in a well. She's suitable for coastwise cruising, and a reasonable project for the skilled amateur builder.

We've adapted the rigs from some of our other tabloid yachts for use on *Ragnar* and these are shown in the silhouettes above.

**21:** This is a variation on the 20-footer, with a radically modified underbody, for better performance in lighter airs and the prospect of improved tacking ability. (Our 20-footer would do 80 degrees tack-to-tack, though, so is no slouch....) Built carefully, she can be quite a bit lighter and still have the classic Friendship Sloop appearance.

**25:** An enlarged version of the 20' Gaff Sloop, this 25-footer extends the flair of her little sister. Her main cabin has 6'-2" headroom and 6'-6" berths each side. Hinged upper berths could be fitted, to function as backrests during daytime, or the starboard berth could be made to extend to a double. The head is forward in its own compartment, and a 10 h.p. inboard diesel engine, although an outboard could alternately be fitted, if preferred. With the same hull and interior arrangement as the 25' Gaff Sloop, the Marconi Cutter offers a slightly different sail type for those who feel more at home on a Marconi rig.

**26:** A slightly longer version of the 25, with a fin keel underbody, this one has an arrangement that will be very comfortable for a couple to vacation or live aboard. The sleeping area is forward, out of the living and socializing in the saloon. There is an enclosed head, a one-fold chart table, good sized galley, guest/sea berth, settee and drop-leaf table with good room for two couples.

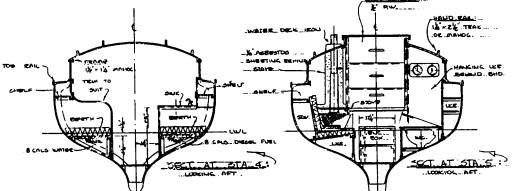
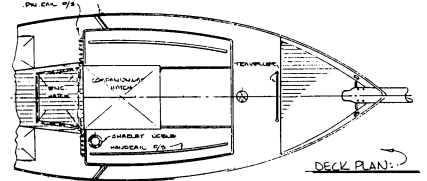
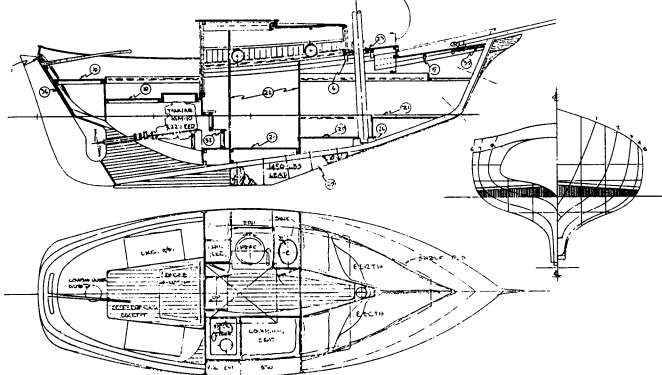

20' Gaff Sloop Ragnar (Roy Montgomery photo)

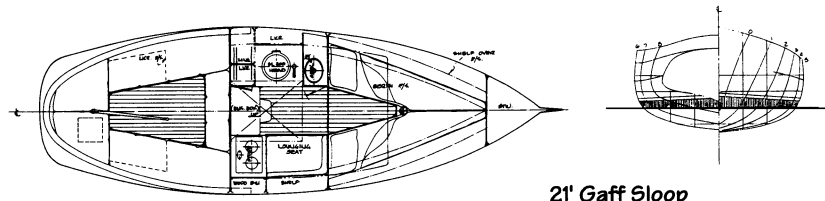
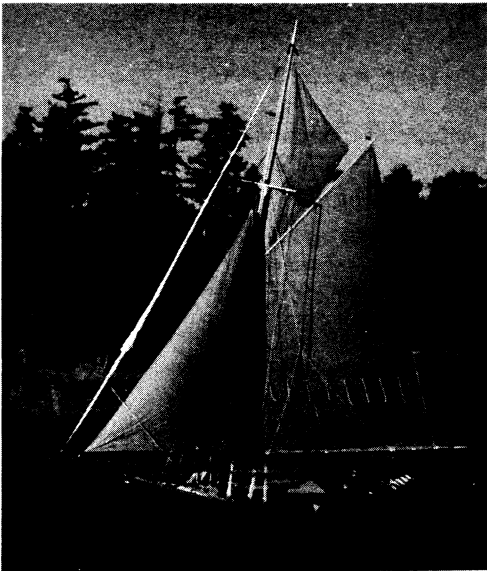

21' Gaff Sloop

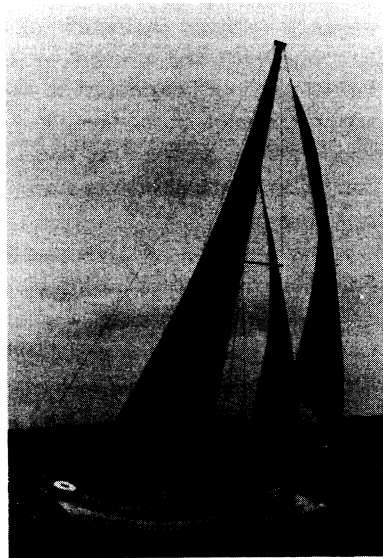
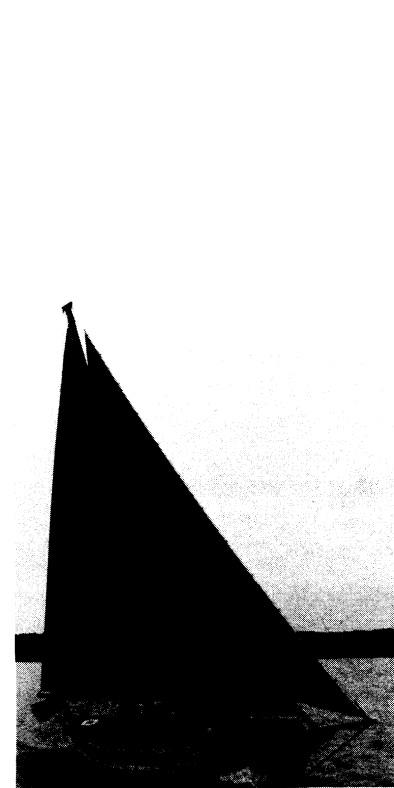
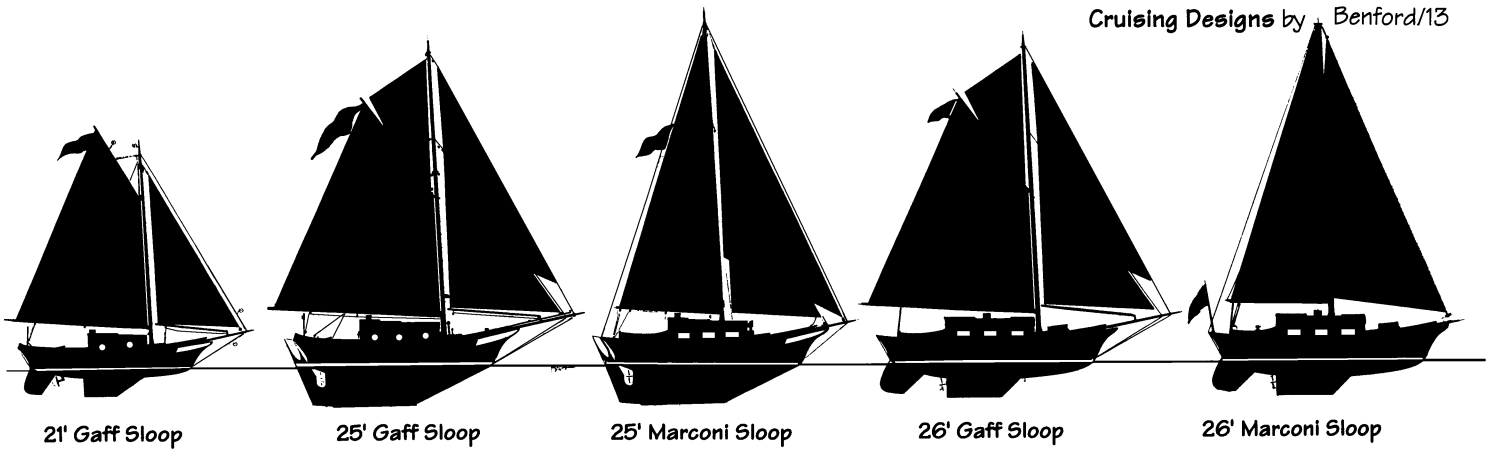

26' Marconi Sloop  
by Tony Cox

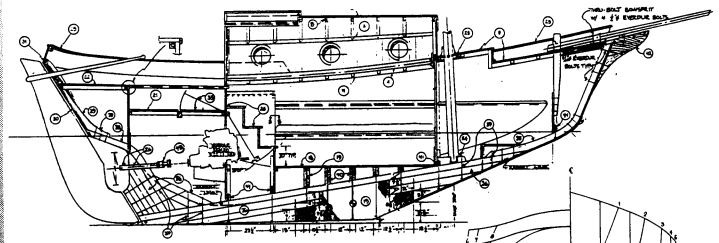

25' Gaff Sloop

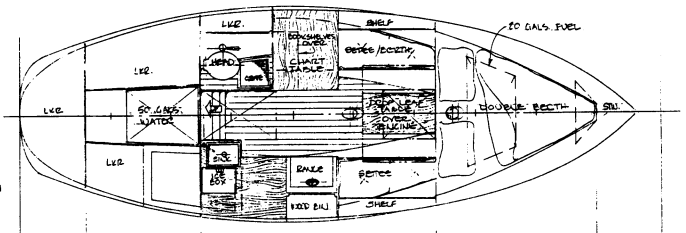
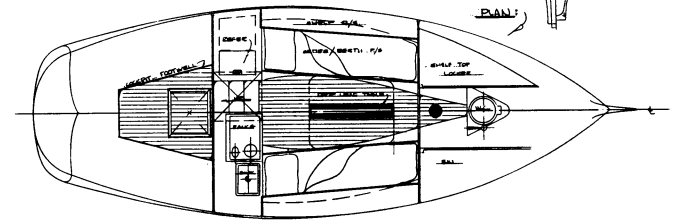

26' Gaff Sloop

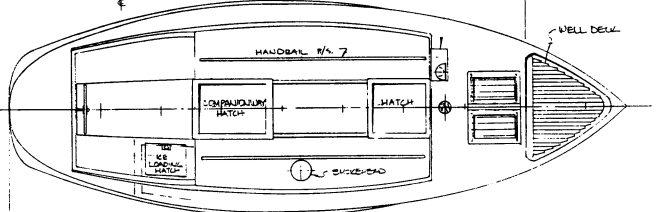
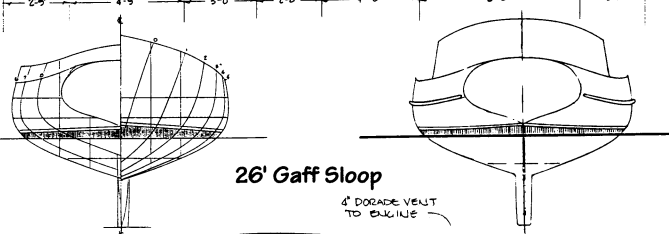

Particulars:	68	160	91	138
Length Overall	20'-0"	21'-6"	25'-0"	26'-6"
Length Designed Waterline	16'-0"	17'-0"	20'-0"	21'-6"
Beam	7'-0"	7'-1"	8'-9"	9'-0"
Draft	3'-0"/4'-0"	3'-0"	3'-9"/4'-6"	3'-9"
Freeboard: Forward	3'-7"	3'-4 1/4"	3'-10"	4'-4"
Least	1'-10 1/2"	1'-10 3/4"	2'-4"	2'-4"
Aft	2'-4"	3'-0"	2'-11"	3'-3"
Displacement, Cruising Trim, Lbs.	3,600/4,200	3,000	7,000/7,600	6,600
Displacement-Length Ratio	392/458	273	391/424	296
Ballast, Pounds	1450	900	2,000	2,400
Ballast Ratio,	35/40	30	26/29	36
Sail Area, Square Feet	210	260	350	350
Tops'l. Rig W/Genoa, Sq. Ft.	300	300	515	515
Sail Area-Displacement Ratio	12.91/14.30	20.00	15.30/14.49	15.92
Topsail Rig W/Genoa	18.44/20.43	23.08	22.52/21.32	23.42
Prismatic Coefficient	.51	.51	.51	.56
Pounds Per Inch Immersion	357	374	558	605
Water/Fuel Tankage, Gals.	15/12		14/20	50/20
Headroom	5'-0"	4'-4"	6'-2"	6'-0"

# BENFORD ★ DESIGN ★ GROUP

Naval Architects & Consultants ★ Specializing In Yacht Design

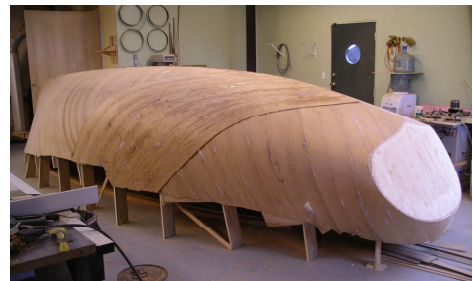

## 21' Gaff Sloop – Design number 160

Length overall	21'-6"
Length designed waterline	17'-0"
Beam	7'-1"
Draft	3'-0"
Freeboard:	
Forward	3'-4¼"
Least	1'-10¾"
Aft	3'-0"
Displacement, cruising trim	3,000 lbs.
Displacement-length ratio	273
Ballast	900 lbs.
Ballast ratio	30%
Sail area	260 sq. ft.
Sail area-Displacement ratio	20.0
Prismatic coefficient	0.51
Pounds per inch immersion	374

This beautiful rendition of our 21' Gaff Sloop was built by a professional builder, Paul Miller, for his own use and pleasure. She was launched in mid 2006 and sails in the Canadian Gulf Islands. Her construction is of wooden strips with cold-molded veneers over, sheathed with a layer of cloth set in epoxy.

The photos show her being built, with the strip planking in place, the veneers being applied, the sheathing in place, prior to painting, the completed boat being set on the ballast, trailering to the launching, and sailing.

