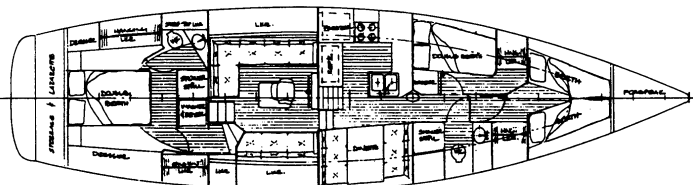
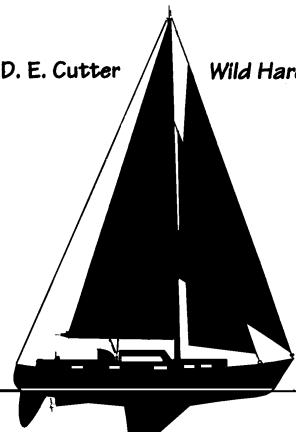
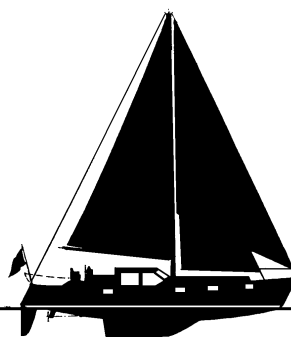
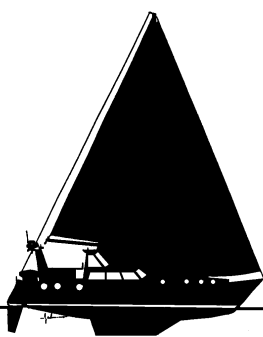
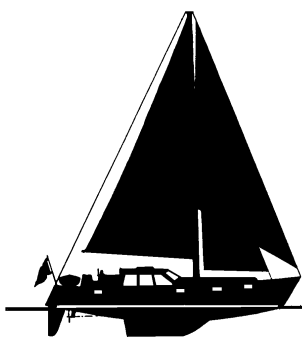

Kanter-Benford 54

54.5' Pillothouse Cutter *Ramblin Rose*

Kanter-Benford 59

60' D. E. Cutter

Wild Hare

Kanter-Benford 54

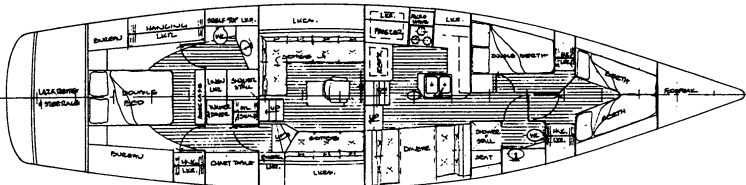

Kanter-Benford 59

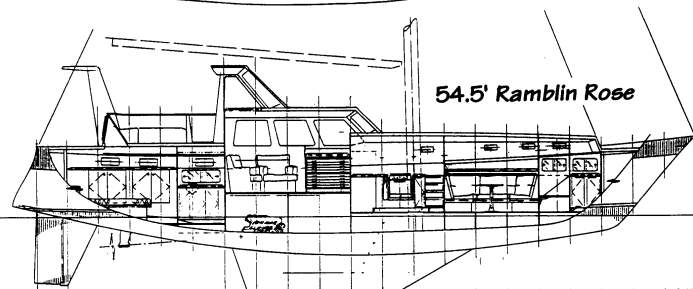
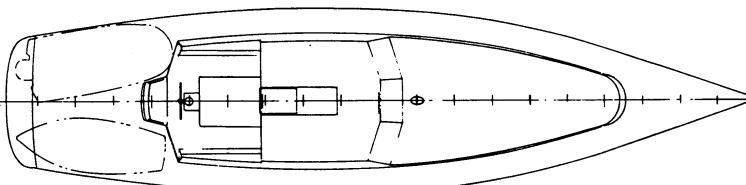
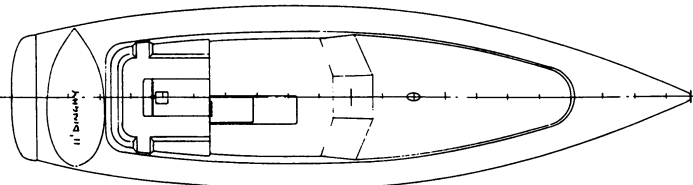
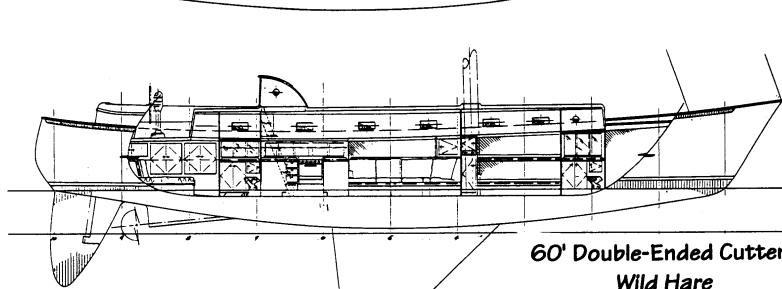
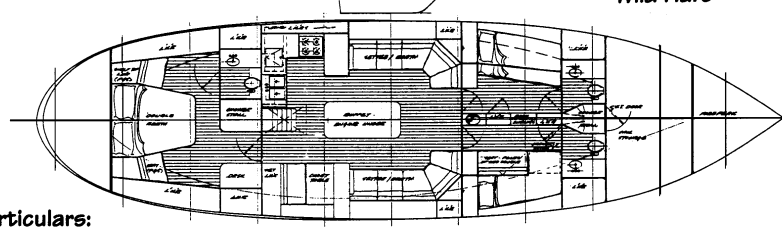
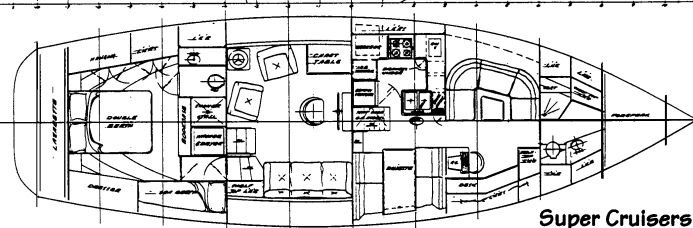
54.5' *Ramblin Rose*60' Double-Ended Cutter
Wild Hare

Super Cruisers Particulars:

Size	54'	54.5'	59'	60'	65'	67'	67'-5"	72'
Length Overall	54'-0"	54'-6"	59'-0"	59'-11½"	65'-0"	67'-0"	67'-5"	72'-0"
Length Datum Waterline	46'-0"	45'-0"	51'-1½"	53'-9"	53'-3"	63'-0"	58'-3"	62'-0"
Beam	14'-9"	16'-11"	15'-0"	16'-1½"	15'-3½"	15'-4"	15'-8"	16'-0"
Draft	6'-0"	6'-0"	6'-0"	9'-0"	6'-4"	6'-0"	6'-5"	6'-9"
Freeboard:								
Forward	6'-6"	6'-5"	6'-6"	7'-0"	6'-10"	5'-10½"	6'-2"	6'-10"
Least	4'-7"	4'-7"	4'-6"	4'-9"	5'-0"	3'-11½"	4'-5½"	5'-0"
Aft	5'-0"	5'-9"	5'-0"	5'-11"	5'-5"	4'-4½"	4'-9½"	5'-5"
Displ., Cruising Trim*	50,000	61,750	56,000	60,000	63,500	62,250	68,600	70,000
Displacement-Length Ratio	229	303	187	172	188	111	155	131
Ballast	12,000	11,800	13,000	22,470	16,000	16,000	19,800	17,500
Ballast Ratio	24%	19%	23%	37%	25%	26%	29%	25%
Sail Area, Square Feet	1,208	1,169	500	1,650	1,410	1,640	1,944	2,002
Sail Area-Displ. Ratio	14.24	11.97	22.1	17.23	14.17	16.71	18.56	18.86
Prismatic Coefficient		.563		.57	.643	.574	.553	
Pounds/Inch Immersion	2,325	2,369	2,600	2,848	2,815	3,130	3,206	3,270
Auxiliary, Horsepower	110	140	140	130	130	200	140	170
Water, Gallons	400	550	500	421	500	225	600	600
Fuel, Gallons	400	400	400	200	500	840	590	600
Headroom	6'-5"	6'-6"	6'-6"	6'-10"	6'-6"	6'-5"	6'-5"	6'-6"

***Caution:** The displacement quoted here is for the boat in coastal cruising trim. That is, with the fuel and water tanks filled, the crew on board, as well as the crews' gear and stores in the lockers. This should not be confused with the "shipping weight" often quoted as "displacement" by some manufacturers. This should be taken into account when comparing figures and ratios between this and other designs. Also, loading down for voyaging and living aboard, as with the May's *Canvasback*, will add considerably to these figures, perhaps as much as 20%. Designs like *Canvasback* which load down gracefully and still sail well make a good choice for voyaging on a super-cruiser.

Kanter-Benford 65 Canvasback

67' Pilothouse Ketch Thumper

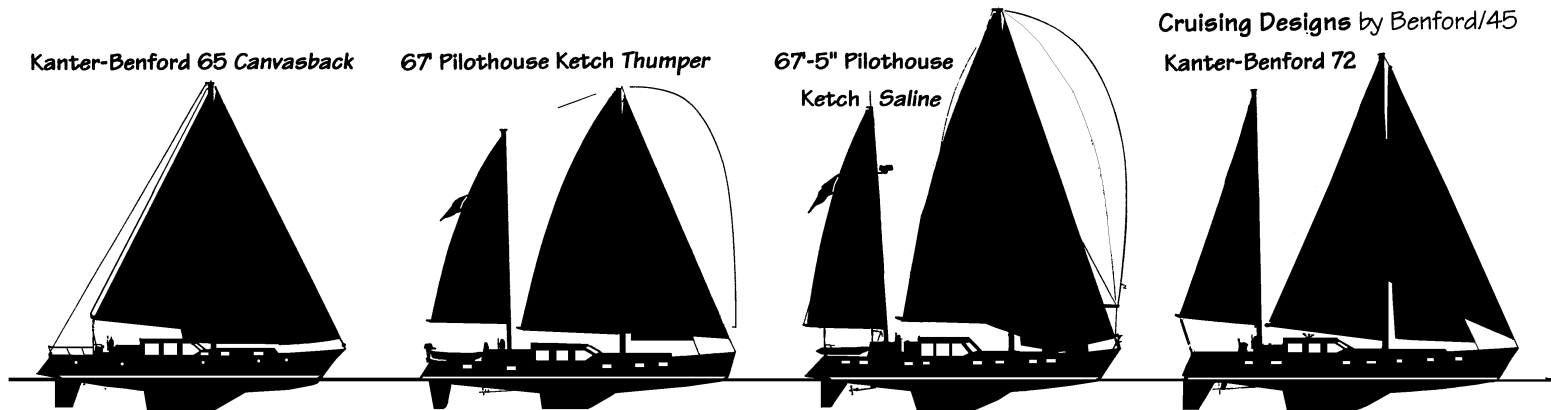
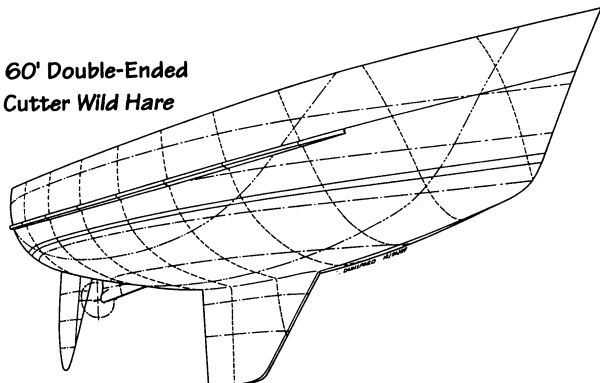
67'-5" Pilothouse
Ketch SalineCruising Designs by Benford/45
Kanter-Benford 7260' Double-Ended
Cutter Wild Hare

Super-Cruisers

54', 54.5', 59', 60', 65', 67', 67'5" & 72' Sailing Yachts
Designs No. 279, 266, 276, 250, 249, 275, 298, 277
1988, '88, '88, '87, '86, '89, '90 & '88

These large sailing yachts are designed and outfitted to make them easy to sail with a small crew and are often handled with just a man and wife aboard. Bill May's 65-footer, **Canvasback**, was the first of this series built. She was nicely done and outfitted at Kanter Yachts and was the inspiration for the rest of this group of super-cruiser designs.

Canvasback set the theme for most of them, with a rig height that clears the 65' ICW bridges, carrying her dinghies on deck, a functional pilothouse/saloon, a good sized galley and dining area, and owner's suite aft and guest/kids quarters forward. She has a stand-up workshop/engine room under the pilothouse.

Canvasback proved out her abilities as a passage maker, logging 1,000 miles from Florida to Bermuda in five days, motorsailing on only three days.

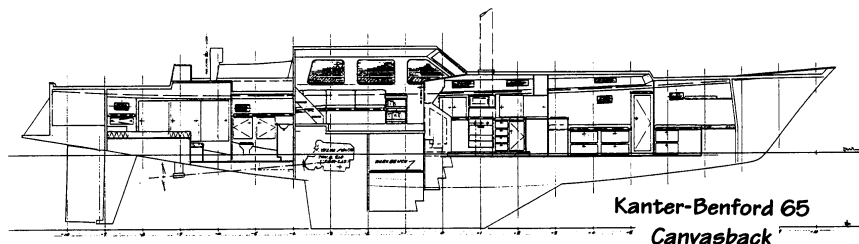
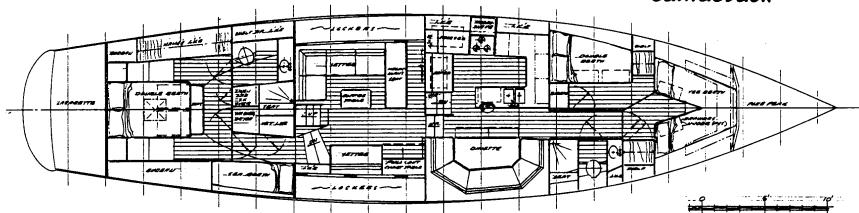

Kanter-Benford 65 Canvasback

Kanter-Benford 65
Canvasback

67' Pilothouse Ketch Thumper

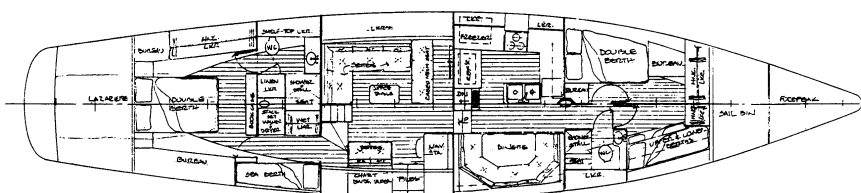
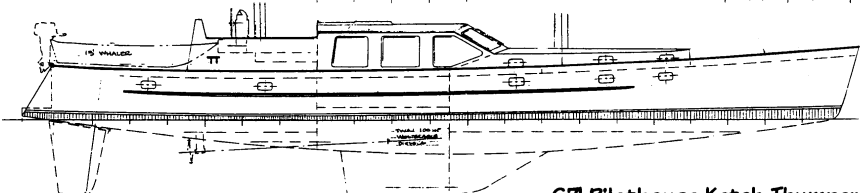

67'-5" Pilothouse Ketch Saline

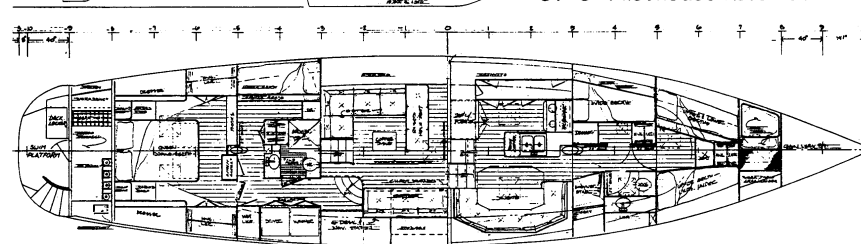
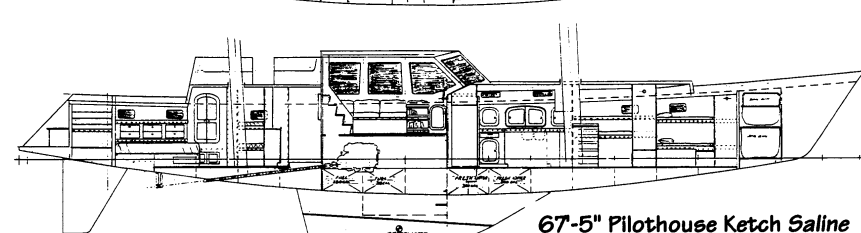

Kanter-Benford 72

