

26' Raised Deck Cutter

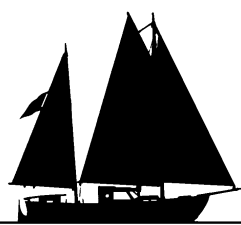

30' Ketch

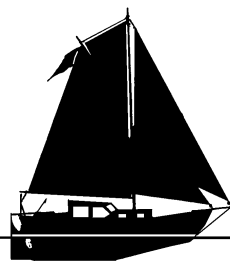

30' Gaff Cutter

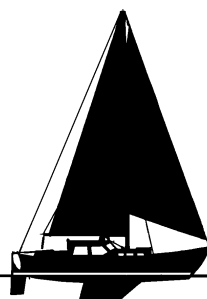

30' Pilothouse Cutter

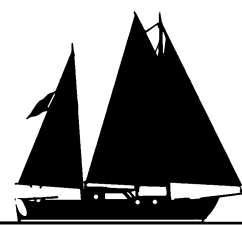

32' Ketch Shoestring

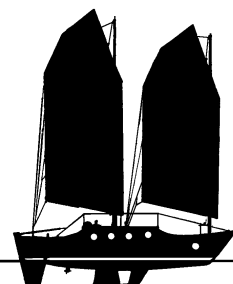

34' Badger

Sailing Dory Designs

The Most Economical Offshore Cruisers

These two pages show our work in designing a series of very affordable offshore cruisers. They are by far and away the most cruising boat for the money and are also very quickly built. This means that you not only get going cruising for less money but you can do it much sooner. Something to think about....

26: This twin keel cutter was designed for a couple to do long distance voyaging aboard. She is capable of doing long voyages, but does not have as generous storage space aboard as the larger ones.

30: This simple-to-construct, no-nonsense little 30-footer will show the performance available with these simply built voyagers. Though flat-bottomed in dory fashion, when she's heeled over, she presents a "V" to the water, and will move along at a good clip. She has 2,400 pound lead ballast on her keel, with plywood, hard chine construction over framing of bulkheads and her furniture. She has an enclosed head, a functional galley and a roomy area for dining and lounging.

32: Named *Shoestring* in honor of one of the first ones built, this name perfectly fits the design philosophy. Intended as an inexpensive cruiser for four, she is another ideal project for the amateur builder — or for the

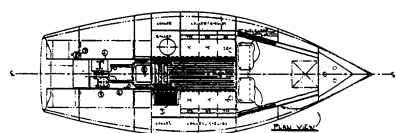

26' Raised Deck Cutter

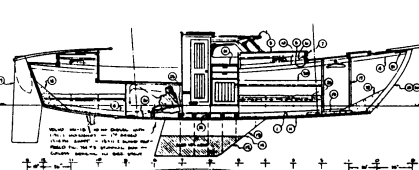

30' Ketch

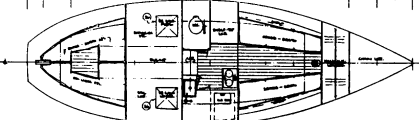

30' Gaff Cutter

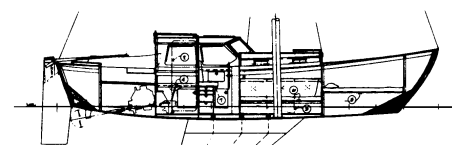
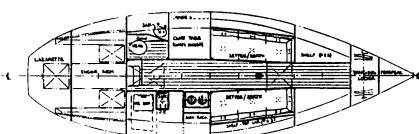

30' Pilothouse Cutter

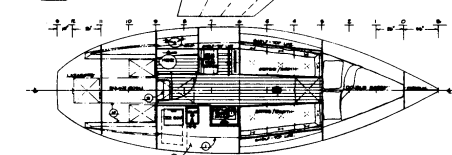

32' Ketch Shoestring

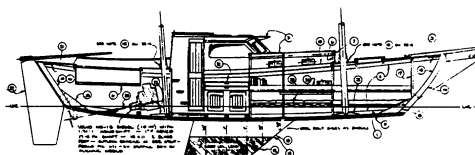

34' Lug Schooner Badger

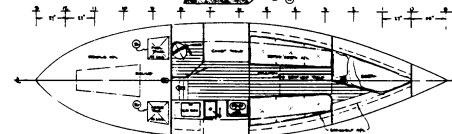

34' Cutter

Sailing Dory Particulars:

Size	26'	30'	32'	34'	36'	37½'
Length Overall	26'-0"	30'-0"	32'-0"	34'-0"	36'-0"	37'-6"
Length Datum Waterline	23'-1"	26'-0"	27'-0"	28'-0"	31'-0"	31'-0"
Beam	9'-9¾"	10'-0"	9'-0"	11'-0"	11'-0"	11'-0"
Draft	3'-0"	4'-0"	4'-0"	4'-6"	4'-6"	4'-6"
Freeboard: Forward	4'-6"	4'-6"	4'-2"	5'-0"	5'-0¾"	5'-2½"
Least	4'-4½"	2'-8¾"	2'-6¼"	2'-9"	3'-0¼"	3'-0¼"
Aft	3'-8½"	3'-3½"	3'-6½"	4'-0"	4'-2¾"	4'-9"
Displacement, Cruising Trim*	8,000	6,700	6,900	10,400	13,425	13,425
Displacement-Length Ratio	290	170	156	211	201	201
Ballast	2,600	2,680	2,760	4,160	5,350	5,350
Ballast Ratio	32.5%	40%	40%	40%	40%	40%
Sail Area, Square Feet	419	500	500	600	700	700/725
Sail Area-Displacement Ratio	16.76	22.5	22.1	20.15	19.83	19.83/20.54
Prismatic Coefficient	.614	.58	.60	.56	.63	.63
Pounds Per Inch Immersion	659			906	983	983
Auxiliary, Horsepower	9	9	9	18	27	27
Water, Gallons	40	25	25	100	110	110
Fuel, Gallons	25	25	25	40	55	55
Headroom	5'3"/6'1"	6'-1"	6'-1"	6'-3½"	6'-4"	6'-4"

***Caution:** The displacement quoted here is for the boat in coastal cruising trim. That is, with the fuel and water tanks filled, the crew on board, as well as the crews' gear and stores in the lockers. This should not be confused with the "shipping weight" often quoted as "displacement" by some manufacturers. This should be taken into account when comparing figures and ratios between this and other designs. Also, loading down for voyaging and living aboard, as with the Hill's *Badger*, will add considerably to these figures, perhaps as much as 50%. Designs like *Badger*, which load down gracefully and still sail well, make a good choice for anyone wanting to go voyaging on a small income.

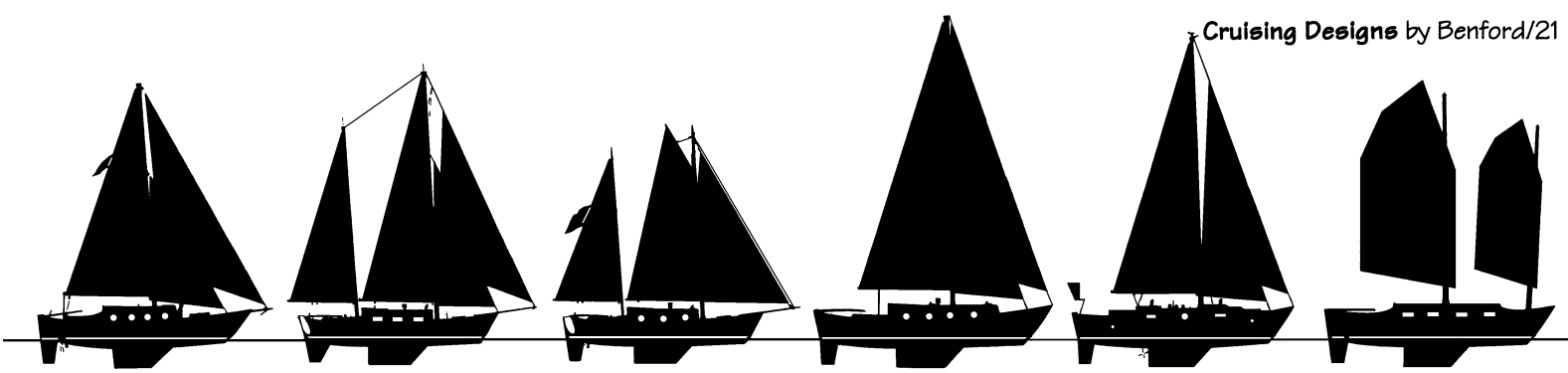

34' Cutter

36' Ketch

36' Gaff Ketch Donna

37½' Cutter

37½' Raised Deck Cutter

37½' Lug Schooner

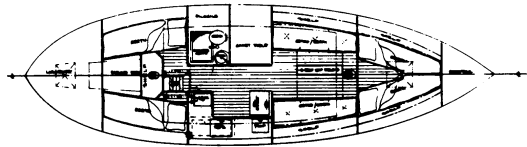

36' Ketch

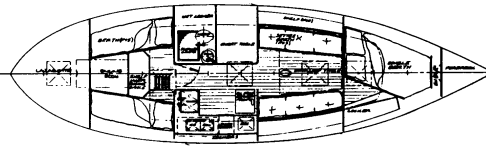

37½' Cutter

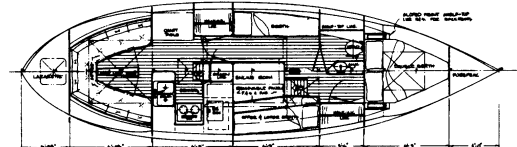

37½' Raised Deck Cutter

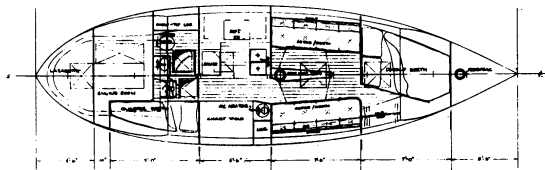
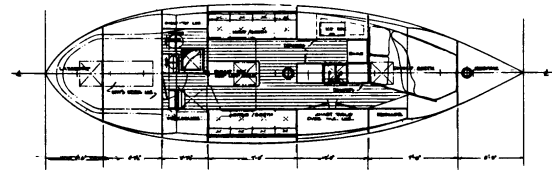
37½' Lug
Schooner
Variations

professional shop who'd like to set up for plywood production on a practical basis. She's slightly longer and narrower on deck than the 30' Sailing Dory, with which she shares her ketch rig, keel and construction details.

34: Badger is the best known of this design. Pete and Annie Hill built her on the proverbial shoestring, producing a very nice and creditable voyager. Annie has written a delightful and informative book about this, **Voyaging On A Small Income**, in which she details how they are able to keep on voyaging on a **very** small income. This is must reading for anyone who wants to spend their life cruising.

36: This relatively light displacement sailing dory with her 5,000 pounds of ballasted keel will move along at a most respectable pace, and still maintain a good deal of stability and solid comfort for her crew. Designed for offshore cruising and simplicity of construction, this practical vessel has very livable accommodations. Quarter berths aft will be most comfortable in a seaway. The head with shower and oilskin locker is conveniently close to the cockpit, and U-shaped galley to starboard. A full-size chart table is next to the enclosed head, with settee-berths midships around drop leaf table. The foc'sle is home to V-berths, or an optional double berth, and the chain locker in the forepeak. There's good amount of stowage space throughout the vessel, especially in the large lazarette.

37½: This is a variation of the 36-footer, with a little more length on deck. They share keels, structural drawings and many of the accommodation variation ideas are interchangeable. It has lug schooner and cutter rigs available.

34' Badger

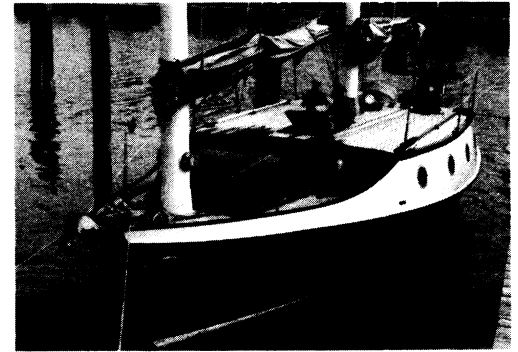

36' Gaff Ketch Donna

