

17' Cruiser

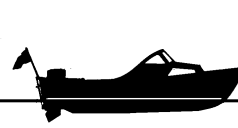

Alternate 17' Cruiser



23' Utility Boat



25' Cruiser

Alternate 17' Cruiser

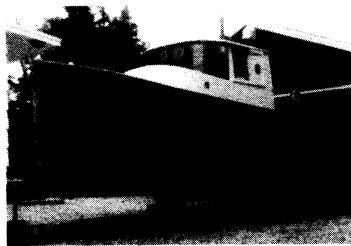

Pocket Cruisers

Designs Number 67/119, 171 & 244

1971/1974, 1978 & 1988

17: She sleeps two, with a head and stove in her cabin. There's a comfortable 6'-3" headroom in the wheelhouse. She'll cruise at 5 knots with 5 to 10 hp diesel inboard. The alternate version will top 10 knots, with 20+ hp.

23: A planing boat, with a cuddy cabin for sleeping and getting out of the weather, plus a place for a portable toilet. She'll power easily with a medium sized outboard, or might be modified to use a stern drive or v-drive.

25: When we started this design, in 1986, we were working with a client who wanted to build it with an outboard engine for power. He'd seen our 20-footer, *Båten*, and wanted a larger version of her. While we later finished it off to use an inboard engine, I still think that she would be very practical with an outboard for power.

The inboard version was done for a fellow with a good engine in a hull that was rotting away. He decided, wisely, that it would be simpler to build a good hull and cabin that try to do a proper restoration on a dying vessel.

If I were building one, I'd want to use one of the small 4-cylinder lightweight turbo-diesels like the Yanmar JH or LH series. This would make for a much smaller engine box in the main cabin and let the galley spaces be a little bigger. It will also give performance that will surprise people who assume that this sort of styling only goes with slow boats....

The 20-foot predecessor, *Båten*, can be found in our book, *Pocket Cruisers & Tabloid Yachts, Volume 1*, with color photos and many drawings.

Particulars:

	17	23	25
Length Overall	17'-0"/17'-1½"	23'-0"	25'-0"
Length Designed Waterline	15'-1½"/16'-0"	20'-0"	23'-9"
Beam	7'-0"	7'-6"	7'-10"
Draft	1'-8"/2'-0"	1'-3"	2'-4½"
Freeboard: Forward	3'-4"	3'-7¾"	4'-6"
Least	1'-11"	2'-3"	2'-9½"
Aft	2'-2"	2'-6"	2'-11½"
Displacement, Cruising Trim, Lbs.	2950/2920	3,335	5,000
Displacement-Length Ratio	321		
Prismatic Coefficient	.667		
Pounds Per Inch Immersion	420		
Water/Fuel Tankage, Gals.	1/15		40/100
Headroom	6'-3"		6'-1½"

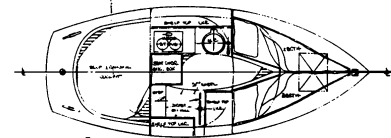
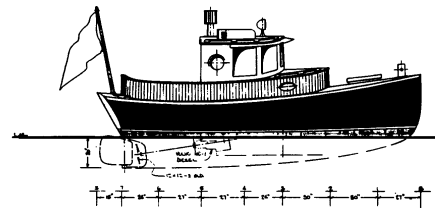

17' Cruiser

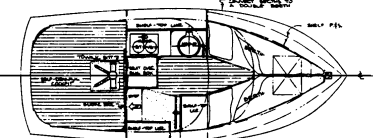
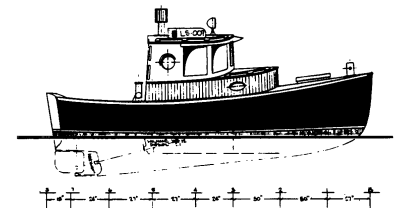

Alternate 17' Cruiser

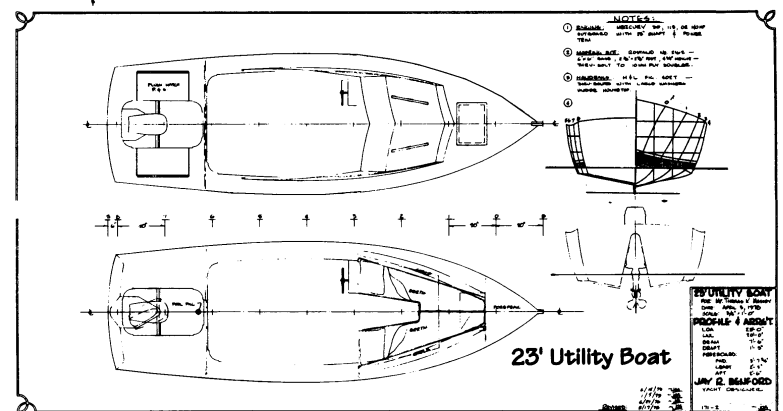

23' Utility Boat

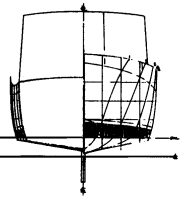
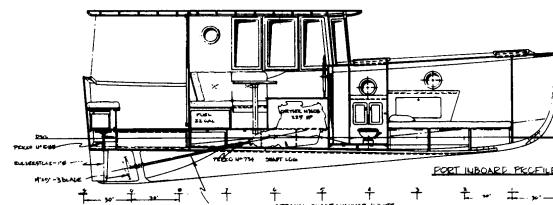
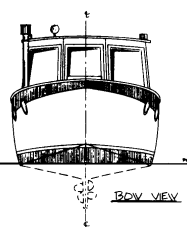
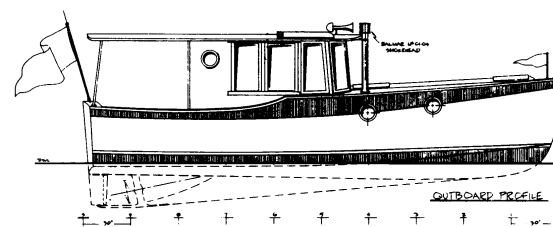

25' Cruiser

