

45' Gaff Ketch

45' Marconi Ketch

45' Optional Tall Ketch

45' Ketch With Hold

50' Marconi Ketch

50' Trader

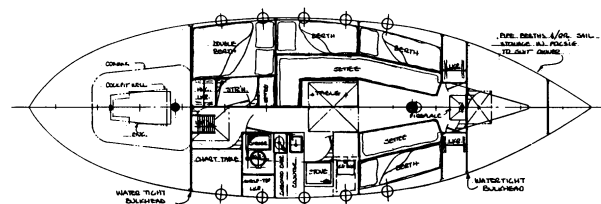

45' Gaff Ketch

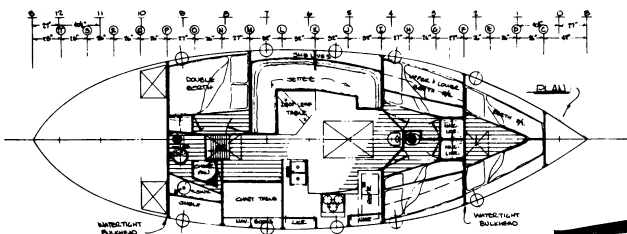

45' D. E. Ketch

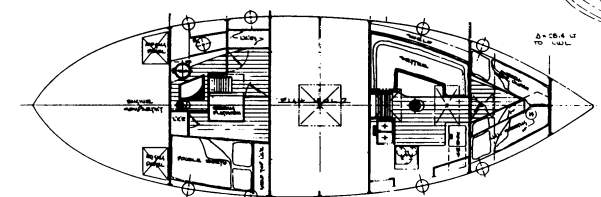

45' Ketch With Hold

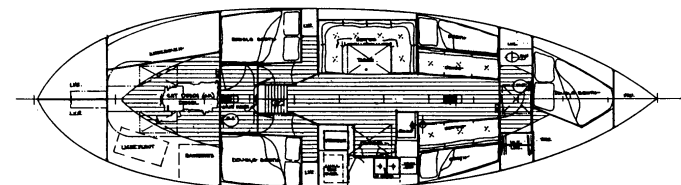

50' D. E. Ketch

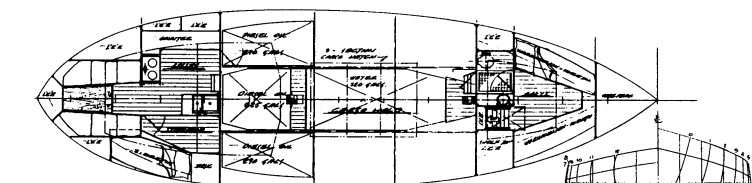

50' Trader

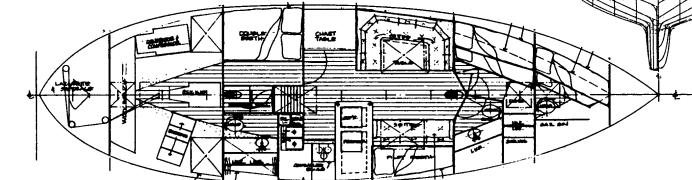

Alternate 50' Ketch Layouts

## Offshore Double Enders

45' & 50' Double Ended Ketches & 50' Trader

Designs Number 55 & 136

1970 & 1975

A robust, sea-going vessel, the 45-footer is flush decked, short rigged and double-ended for maximum safety in any weather. She sleeps eight in four private staterooms. There is a large galley and dining area, and a head with shower. She's able to carry tremendous stores of fuel, supplies and water for extended cruising. Boats built to this design have done a lot of ocean voyaging, and proven very successful. There's an optional tall Marconi ketch rig, borrowed from the 50-footer, for those who want better sailing performance in lighter conditions.

The optional Gaff Ketch with Topsail rig for the 45' D.E. Ketch has the furling and rigging set-up used by the old West Coast trading schooners, which set quite large sails with very small crews. Square sails can be rigged and furled by one man on deck. Properly rigged square sails are much to be preferred to twin staysails for tradewind sailing. They are easier to control, have less chafe and put less strains on the rig and the crew. Try it — you'll like it!

The 50' Double Ended Ketch was developed for a merchant sailor who wanted a boat like our 45-footer with a few additional features. It's also worked out quite well in practice and proven to be a good sea boat and fast passage maker. The Trader version has a large cargo hold, suitable for carrying cargo or using as a large shop or as additional stateroom spaces.

Particulars:	45' D.E. Ketch	45' Gaff Ketch	50' D.E. Ketch	50' Trader
Length overall	45'-0"	45'-0"	50'-0"	50'-0"
Length designed waterline	40'-6"	40'-6"	43'-0"	43'-0"
Beam	14'-9"	14'-9"	15'-0"	15'-0"
Draft, cruising trim	6'-9"	6'-9"	7'-0"	7'-0"
Freeboard:				
Forward	6'-6"	6'-6"	7'-0"	7'-0"
Least	4'-0"	4'-0"	4'-0"	4'-0"
Aft	5'-0"	5'-0"	5'-6"	5'-6"
Displacement, cruising trim, lbs.	63,800 or 55,200	63,170	63,170	63,170
Displacement-length ratio	429 or 371	355	355	355
Ballast, pounds	18,000 to 27,000	12,500 to 19,000	12,500 to 19,000	12,500 to 19,000
Ballast ratio	28% to 42%	20% to 30%	20% to 30%	20% to 30%
Sail area, square feet	1,100	1,304	1,500	1,575
with optional or square rig	1,500	2,209		2,400
Sail area-displacement ratio	11.0213.07		15.1315.89	
with optional or square rig	15.03	24.38		24.21
Prismatic coefficient	.562	.562	.568	.568
Pounds per inch immersion	1,950	1,950	2,343	2,343
Water/Fuel Tankage, Gallons	430/270	430/270	600/590	320/805
Headroom	6'-5" to 7'-7"		6'-1" to 7'-11"	