

42' Coasting Schooner

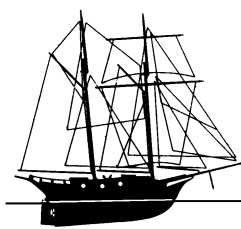

42' La Flaneuse

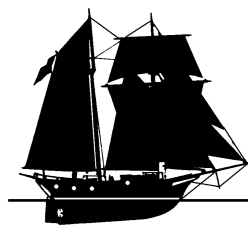

42' Sq. Tops'l Schooner

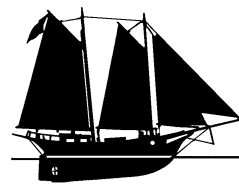

42' South Seas Trader

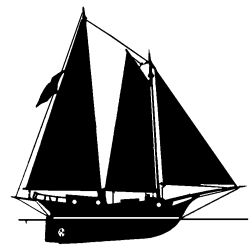

42' Alaskan Trader

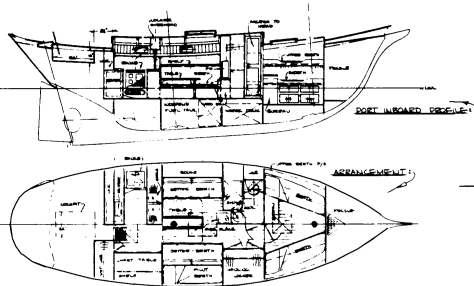

42' Coasting Schooner

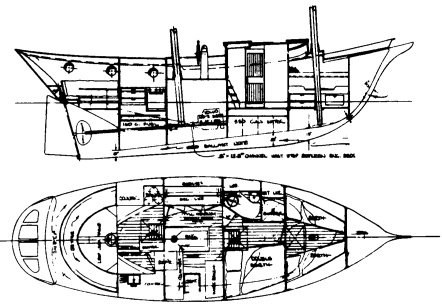
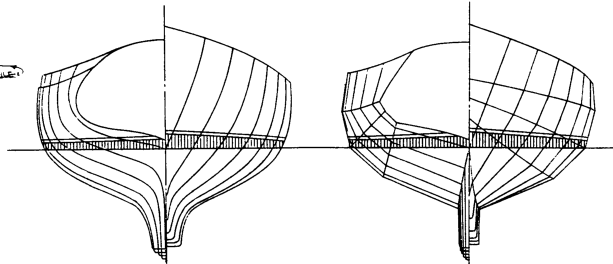

42' Square Topsail Schooner

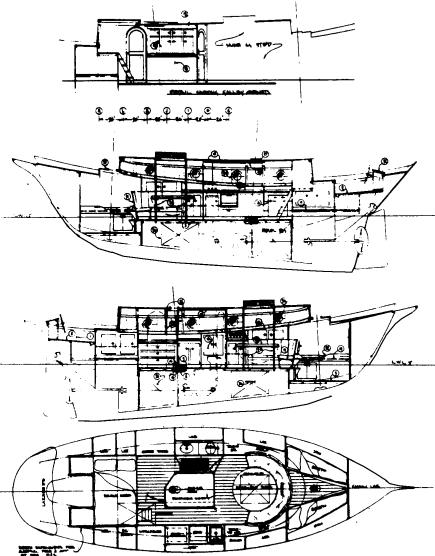

42' Topsail Schooner — La Flaneuse

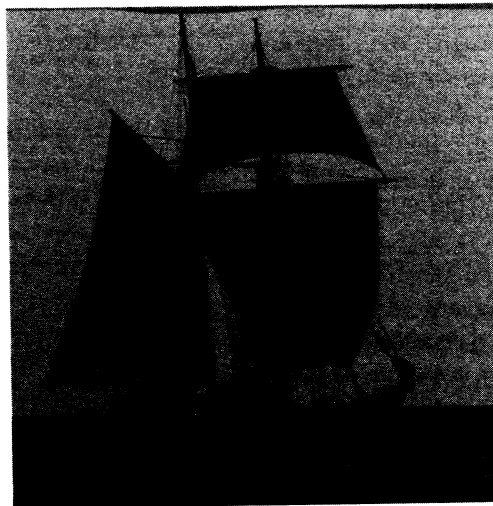

The Benford 42/43 Series

Designs Number 57 & 75
1970 & 1971

The original design in this series is the handsome 42' Topsail Schooner. It has a splendid great cabin aft, with an elliptical settee and table for dining and socializing. The head has a separate shower stall. The engine room has a workbench and desk. The owner's cabin has a double berth and there are single berths in the forward cabin. The passageway under the cockpit provides good fore and aft access.

Other versions and variations have been designed to serve a lot of other uses, from charter work to carrying cargo under sail. Some have had an enclosed pilothouse added to provide shelter from the sun and rain. As these two pages show, there are quite a lot of variations on this basic design. Many of the interior and rigs can be interchanged in whole or in part to create even more versions.

Many of the schooner rigs are variations on the topsail schooner, with or without the topmasts and squaresail yards. Similarly, the 42/43 ketches are available with and without the topmasts and yards.

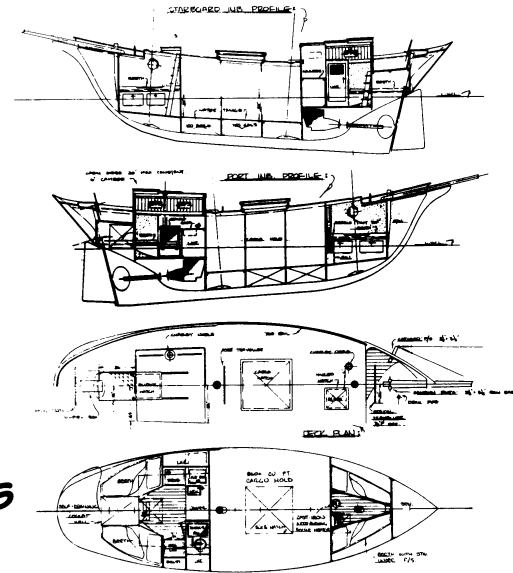

42' Trading Schooner
— South Seas Trader

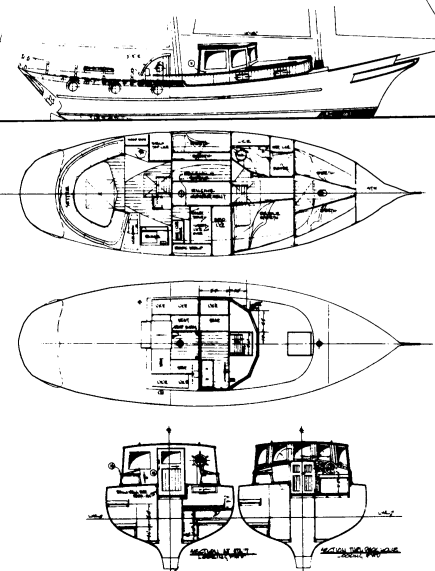

42' Schooner — Pilothouse Version

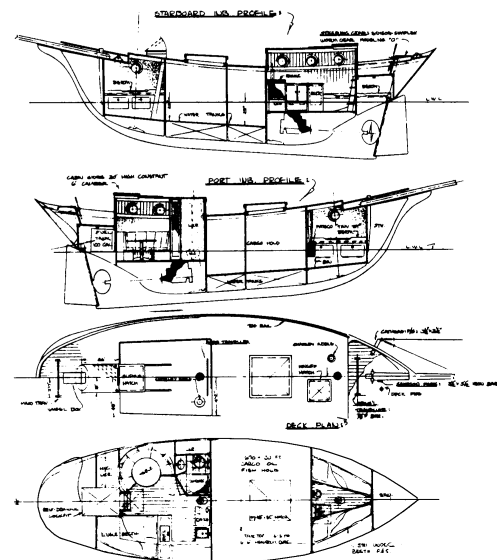

42' Trading Schooner — Alaskan Trader

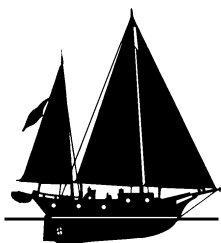

42' Marconi Ketch

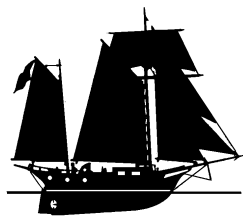

42' Square Topsail Ketch

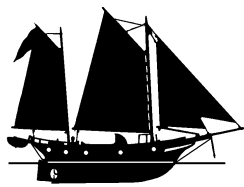

43' Gaff Ketch

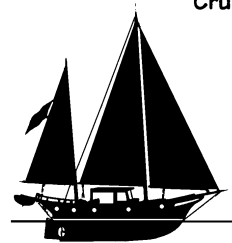

43' Motorsailer #1



43' Motorsailer #2

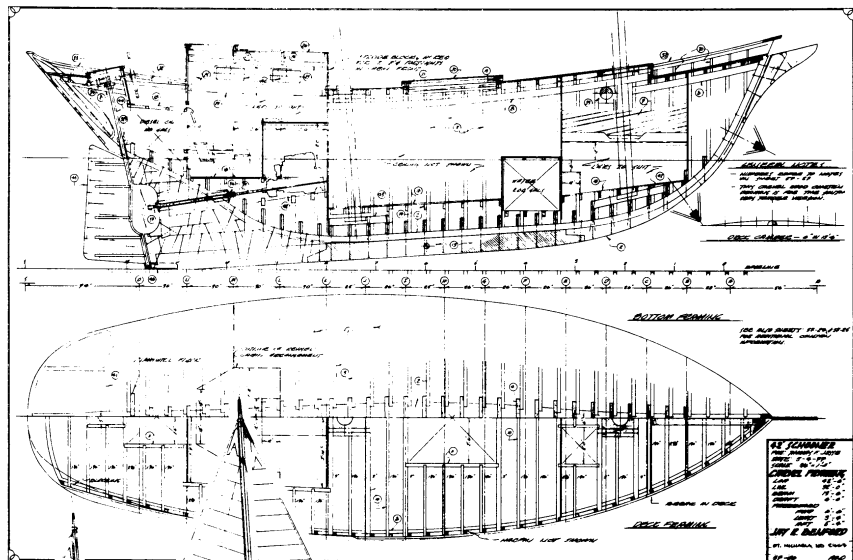

↔ The wood construction plan at left is one of the many detail sheets for this design.

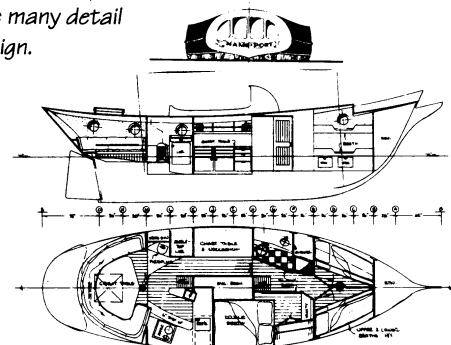
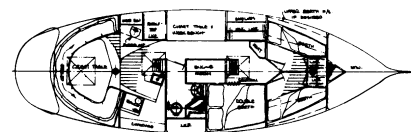

43' Gaff Ketch

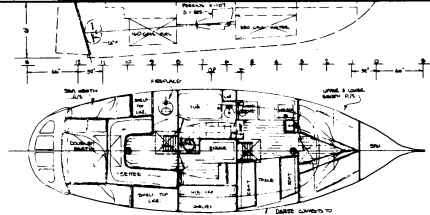
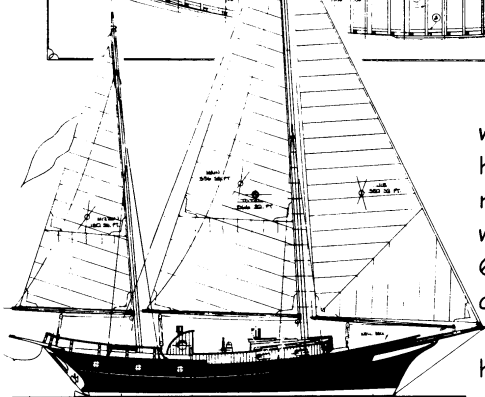

42' Marconi Ketch

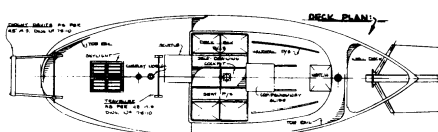

42' Sq. Tops'l Ketch

The 43-footer is a variation on the original 42' hull with the break in the sheer line eliminated and this higher sheer carried out to the new bow length with the resulting gain of 6" of length. The 43 is also available with the keel shortened to give a draft of 5' instead of 6'. In addition to the round bilge hull there is a multi-chine version for building in steel.

Many boats have been built from these plans. They have proven to be very good seaboats, fast passagemakers and as comfortable for long ocean passages as for living aboard in port. From her heart-shaped transom to her clipper bow she's a classic and has proven to be the heart's desire of many delighted cruising families.

Particulars:	#57	Steel	#75
Length overall	42'-6"	42'-6"	43'-0"
Length designed waterline	32'-0"	32'-0"	32'-8"
Beam	13'-6"	13'-5½"	13'-6"
Draft	6'-0"	6'-0"	5'-0"
Freeboard:			
Forward	6'-6"	6'-6"	7'-1"
Least	3'-4"	3'-4"	3'-9½"
Aft	5'-4"	5'-4"	5'-1"
Displacement, cruising trim, lbs.	36,000	33,000	39,000
Displacement-length ratio	490	450	499
Ballast, lbs.	10,800	9,000	10,800
Ballast ratio	30%	27%	28%
Sail area	Varies: 850 to 1,443 sq.ft.		
Sail area-displacement ratio	Varies: 12.05 to 22.44		
Prismatic coefficient	.56	.57	
Pounds per inch immersion	1,487 (Typical)		
Water tankage, Gals.	330	300	300
Fuel tankage, Gals.	160	165	250
Headroom	6'-6" to 6'-9" (Typical)		

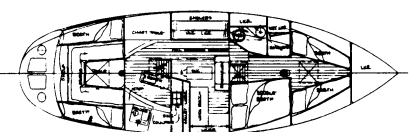
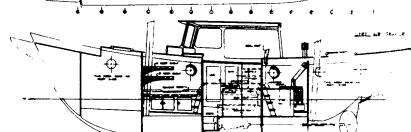
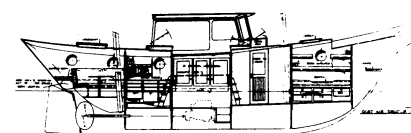

43' Motorsailer #1

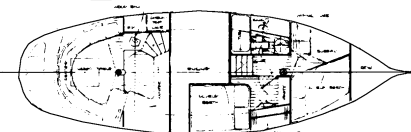
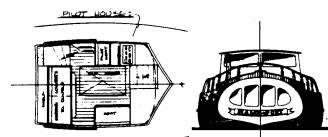

43' Motorsailer #2